



TOWN OF NEWINGTON

MAP OF INLAND WETLANDS & WATERCOURSES



MAPS ADOPTED MARCH 21, 2006 BY THE
NEWINGTON CONSERVATION COMMISSION

MAPS APPROVED MAY 9, 2006 BY THE
NEWINGTON TOWN COUNCIL

13A

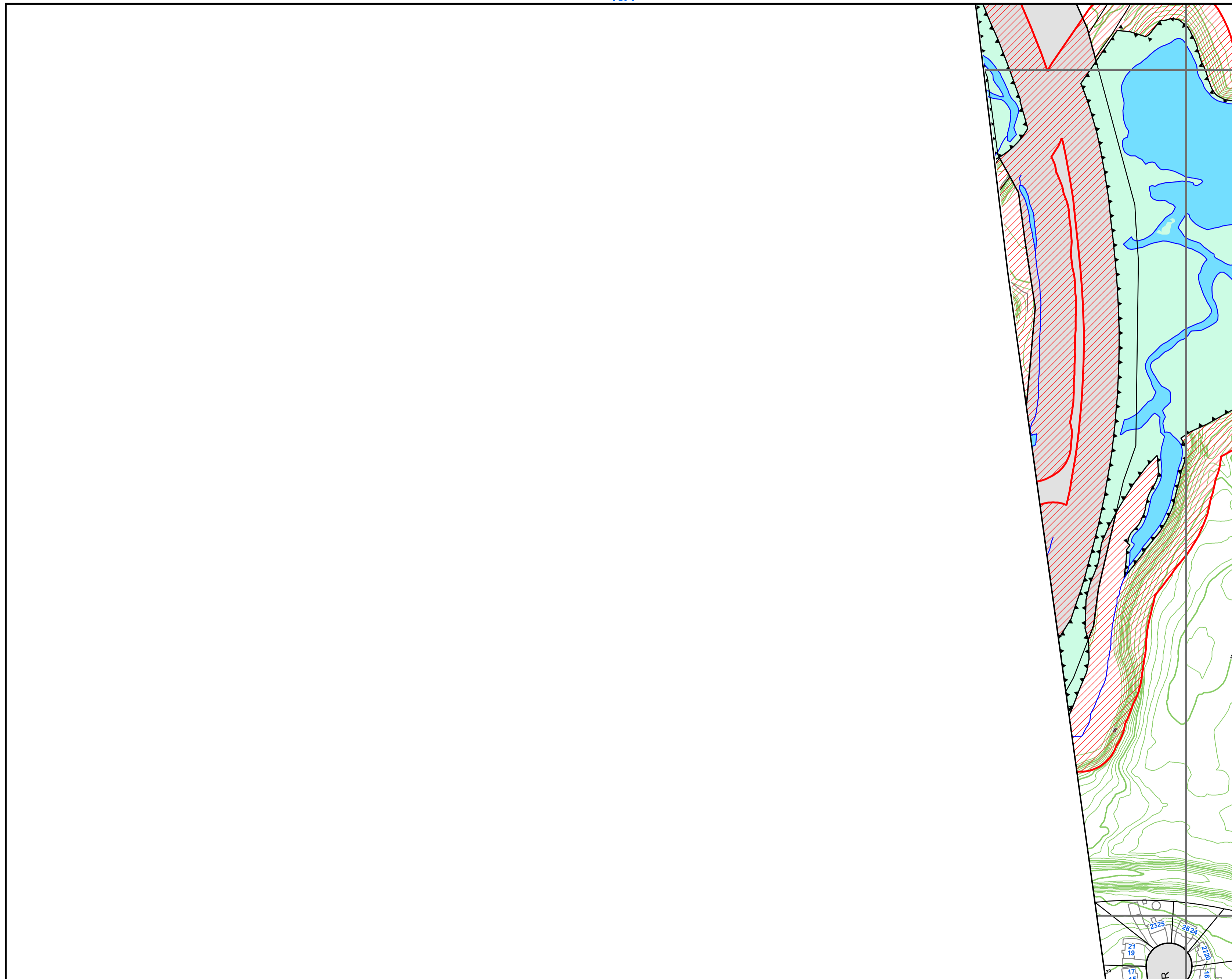

MAP AMENDMENTS

DATE	PERMIT #	LOCATION

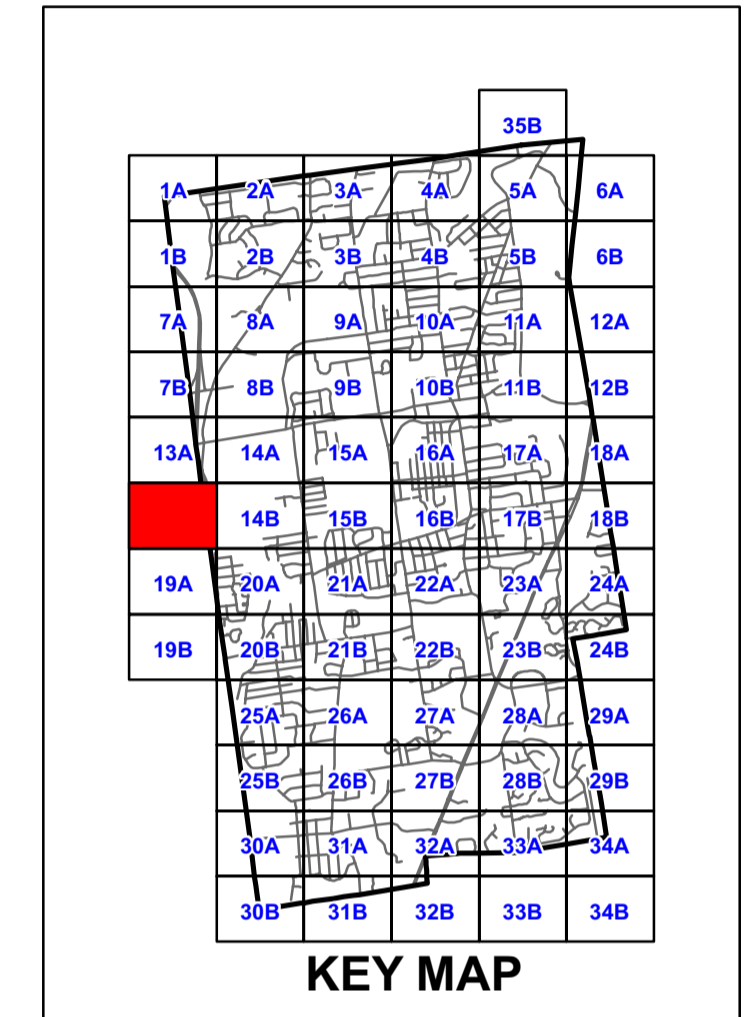

DATE PRINTED: JUNE 1, 2006

LEGEND

Regulated Areas

- | | |
|----------------------------------|--------------|
| Wetlands | Water Bodies |
| 100' Buffer "Upland Review Area" | Water |
| | Water Course |
| | Marsh |

NOTE:

AN ACTIVITY WITHIN THE LEGEND ITEMS NOTED ABOVE **REQUIRES A PERMIT FROM THE NEWINGTON CONSERVATION COMMISSION TO INCLUDE THE 100 FOOT UPLAND REVIEW AREA**

Digital Base Mapping: Provided by the Metropolitan District Commission (MDC)
Horizontal Datum: North American Datum 1983 (NAD 83)
Spheroid: Geographic Reference System (GRS 80)
Vertical Datum: North American Vertical Datum 1988 (NAVD 88)
Units: Mean Sea Level (MSL) Feet

Disclaimer: Property information has been derived from recorded deeds, plot plans, public records, and other data. The intent of this map is to provide the user with a graphical representation of real property for the Town of Newington. The information contained on this map is **NOT** under any circumstance to be construed or used as a "legal description". Maps are a visual representation only, refer to deed and or survey.

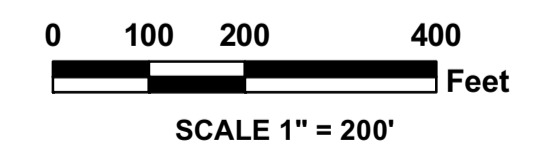

SHEET NUMBER **13B**

19A